

IMPORTANT INSTRUCTIONS

For Foredom® Handpieces H.18, H.18D, and H.18SJ

Before attaching this Handpiece please read these instructions.

- Keep a 2.35mm (3/32") shank in the handpiece at all times, during operation and storage.
- For easier bur removal, push bur in slightly to release collet taper before pulling bur out.

- Never depress collet release lever while flexible shaft is rotating. The release lever is not intended for use as a brake.

Always use a proper dust collection system or wear a respirator to prevent the inhalation of dust particles, or other debris into the lungs.

Keep both hands and fingers away from the cutting edge at all times.

Never wear open shoes or sandals. Use footwear that is tough enough to protect your feet from falling tools.

Never cut or exert pressure toward your hand or any other part of your body.

Do not wear loose fitting clothing or jewelry. Loose clothing or jewelry can become entangled in the tool. Do not wear items such as neckties, necklaces, or bracelets when operating power tools. Secure or tie back long hair.

Let the speed of the tool do the work.

Wear safety glasses or a face shield whenever you operate a Foredom Flexible Shaft machine or any power tool to prevent serious eye injury.

Never use a damaged, bent, vibrating, or out of balance accessory or other tool bit. Inspect each accessory for cracks or flaws before using.

Never change accessories while motor switch is in the ON or FOR (forward) or REV (reverse) position.

Secure the workpiece that you are carving in a vise or other work holding device. Holding it with your hand is dangerous and can result in serious hand injury.

Adjust Shaft & Sheath

It is important to check the sheath and shaft tip and properly adjust them before attaching this handpiece to your Foredom flex shaft tool. The tip of the flexible shaft should extend 3/4" beyond the end of the sheath. This adjustment is made by loosening the set screw in the motor connector and moving the sheath in or out while the motor and shaft/sheath are hanging fully extended or laying on a flat surface. When the shaft is adjusted correctly, tighten the set screw in the motor connector.

Attach Handpiece to Flexible Shaft

Before attaching the handpiece, connect the motor to the speed control and plug into power source.

To Attach Handpiece: while holding the black colored metal outer sheath tip facing upward, turn on the control so that the motor is running at about half speed and then turn it off. While the inner key tip is still rotating, grip the handpiece and push it onto the sheath tip with one firm motion until it snaps into place (shown at right). This procedure will align the key tip into the keyway slot (shown above). To verify this, insert and tighten an accessory into collet or chuck, turn on control to a low speed and observe that the accessory rotates smoothly.

To Remove Handpiece from Flexible Shaft:

1. First make sure your power tool is unplugged.
2. To remove, simply pull the handpiece off the shaft and sheath with a firm grip.

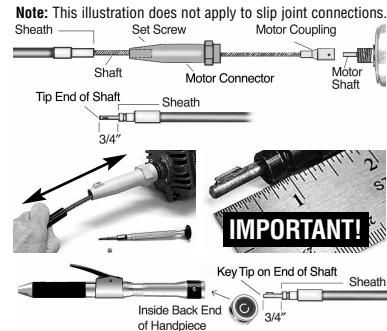

Operation

These Quick Change handpieces have a unique lever action collet release mechanism for rapid accessory changes. Wait for the motor, flexible shaft and accessory to come to a complete stop before pressing the lever to open collet. Press bur in slightly before removing.

Never depress collet release lever while flexible shaft is rotating! This can cause damage and extensive wear to the handpiece!



Press lever to release collet.

Release lever to close collet.

Lubricate H.18D ONLY

Lubrication of Duplex Spring Connection on H.18D Handpiece

Apply 2 drops of oil in oil hole on rear of duplex spring connection approximately every 20 hours of use.

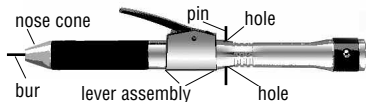

Maintenance and Lubrication

Handpieces H.18 and H.18SJ never need lubrication. Putting oil or grease into the front or back of these handpieces will damage their pre-lubricated ball bearings.

Flex Shafts: Cleaning and lubrication should be performed every 50 hours of use: First be sure to unplug your power tool. Remove handpiece and then loosen set screw in motor connector (see previous page) and remove sheath. The exposed shaft should be wiped clean with a cloth and solvent. Apply a **light film** of Foredom grease (part no. MS10006) to entire length of inner shaft. Reconnect shaft and sheath, following adjustment procedure on previous page and run motor for ten minutes before reconnecting handpiece. Turn off motor, wipe off excess grease from tip of drive shaft and reconnect to the handpiece.

Collet Replacement Instructions for H.18, H.18D and H.18SJ Handpieces

Keep a 3/32" shank bur with same size or smaller head in the handpiece.

1. Disassembly of Nose Cone:

Tools required: smooth grip pliers and 1/2" open end wrench.

A. Grasp housing with smooth grip pliers or firmly grip handpiece at base of lever assembly.

B. Place 1/2" wrench over flats on nose cone and unthread.

2. Disassembly of Nosepiece and Collet:

Tools required: pin (3/32" or 2.3mm diameter) and 1/4" open end wrench.

A. Lock spindle by inserting pin through holes in handpiece behind lever assembly. You may need to rotate bur for the pin to go all the way through.

B. Place 1/4" wrench over flats on nosepiece and unthread.

C. Remove Collet.

3. Required for Reassembly: pin, 3/32" or 2.35mm diameter bur with head diameter less than 3/32", Foredom Oil **MS10010**, 1/4" and 1/2" wrenches, and Replacement Collet **HP703**.

A. Blow out spindle, replacement collet, and nosepiece with compressed air.

B. Wipe tapered collet seat clean.

C. Lock spindle by inserting pin through holes in handpiece rotating bur as needed.

D. Insert pin or bur with small head into collet. Insert collet with pin into spindle.

E. Hand thread nosepiece over collet and pin or small bur onto spindle. Place 1/4" wrench over flats and tighten firmly.

F. Place a small drop of Foredom Oil on nose cone threads. Thread nose cone onto housing. Tighten with 1/2" open end wrench.

4. Collet Inspection:

Depress lever. Bur must enter and exit collet freely, but not fall out. If collet sticks to taper in nosepiece or plunger, it will appear as though bur is stuck. To unseat, simply push bur in firmly and remove slowly again while holding lever down. If bur continues to hang up, remove nose cone and nosepiece, spread collet fingers, reassemble and test.

Repair Service

Factory repairs are done promptly and at reasonable cost. If you wish, you can send your equipment directly to the factory marked:

"Attention: Service Department". Be sure to give your street address, daytime phone number and/or email address and include a brief note describing the problem with the equipment. Estimates will be made upon request.

Please retain your proof of purchase for warranty repairs.

For More Information on Foredom machines, handpieces, or accessories, contact your local dealer. When no local dealer is available, write: **The Foredom Electric Company**
16 Stony Hill Road, Bethel, CT 06801
call: (203) 792-8622, visit our website at: www.foredom.net or email: customerservice@blackstoneind.com

LIMITED WARRANTY

Your Foredom Quick Change Handpiece is warranted against defective material and workmanship for a period of 90 days from date of purchase. The duplex connection is particularly susceptible to damage and is not covered by warranty. Replacement duplex springs are shipped with installation instructions. Blackstone Industries, Inc. d/b/a The Foredom Electric Company warrants, to the original purchaser only, that its products will be free from defects in material or workmanship for the applicable period of time indicated above following the purchase date. During the warranty period, the defective product will be repaired or replaced without charge or, at our sole option, the purchase price will be refunded. This warranty does not cover damage caused in transit or by accident, misuse or ordinary wear.

ALL IMPLIED WARRANTIES INCLUDING, WITHOUT LIMITATION, IMPLIED WARRANTIES OF FITNESS FOR A PARTICULAR PURPOSE AND MERCHANTABILITY, ARE LIMITED IN DURATION TO THE APPLICABLE WARRANTY PERIOD. IN NO EVENT WILL WE BE LIABLE FOR ANY INCIDENTAL OR CONSEQUENTIAL DAMAGES. Some states do not allow limitations on how long an implied warranty lasts or the exclusion or limitation of incidental or consequential damages, so the above limitations or exclusion may not apply to you. At our sole option, repair, replacement or refund will be made if the product is returned postage prepaid to:

The Foredom Electric Company, 16 Stony Hill Road, Bethel CT 06801

All warranty repairs must be done at our factory at the above address. We will not pay any shipping or transportation charges. Armatures, bearings, shafts, sheaths and duplex springs are not covered by this warranty. This warranty gives you specific legal rights, and you may also have other rights which vary from state to state.